

LEDLENSER Flex10

1

Input port (Micro USB)

Lock-Unlock Wheel

LED Indicators

Output port (USB-A)

Power Button

Input/Output port (Type-C)

2

Output port (USB-A)

Input/Output port (Type-C)

100% ●●●●

75% ○●●●

50% ○○●●

25% ○○○●

0% ○○○○

3

1x click

3xblink ●○○○

100% ●●●●

75% ●●○○

50% ●○○○

25% ●○○○

0% ○○○○

4

USB charging cable

Input port (Micro USB)

Input/Output port (Type-C)

PC

100% ●●●●

75% ●●○○

50% ●○○○

25% ●○○○

0% ○○○○

5

New 21700

21700

Ledlenser Product

LEDLENSER Flex10

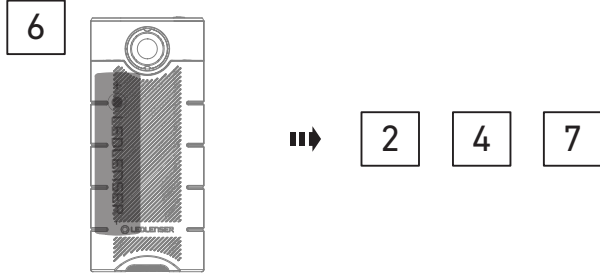

7 Low current function

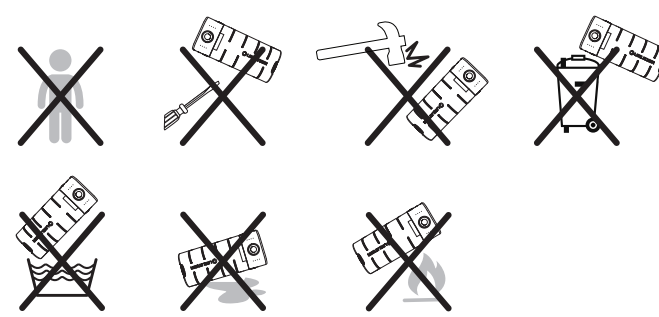
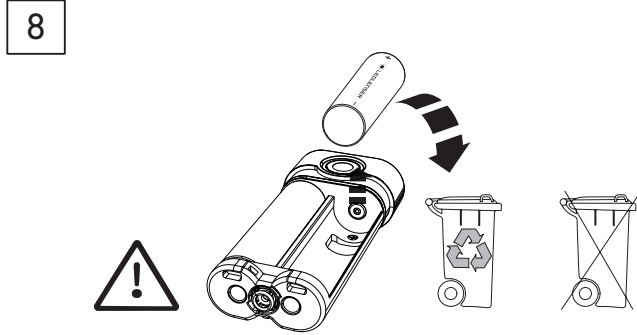
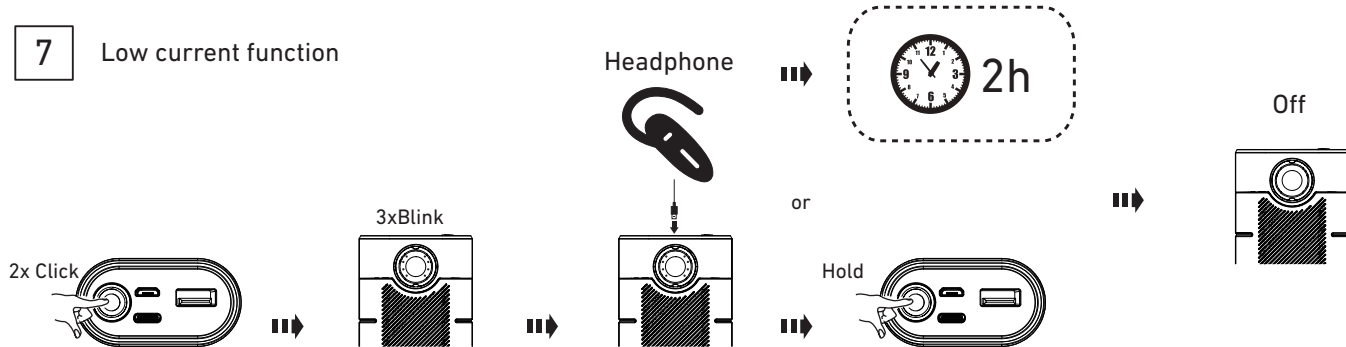

Ledlenser GmbH & Co. KG
 Kronenstrasse 5-7 • 42699 Solingen • Germany
 Phone +49 212/5948-0 Fax +49 212/5948-200
 info@ledlenser.com

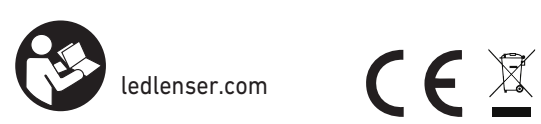

1J12A0475
 Flex10 QUG_V1
 2021.05.11